

SITE PLAN OF SANKA GOVT. P.T.T.I COLLEGE CAMPUS
MOUZA- SANKA, J.L NO-116, PLOT NO-5032,5526.
LATITUDE- 23.526733, LONGITUDE- 86.628217

All Dimensions are in Meter.
Scale- N.T.S

Sl no	Building Name	Description of building	Remarks
1	Office building with classroom	RCC Frame structure. (Single Storey)	Old Building. Repair,renovation works done in the year 2018-19. Detailing of foundation- Record not found.
2	Classroom	RCC Frame structure. (Single Storey)	Construction from lintel level to roof has been done in the year 2018-19. Detailing of foundation- Record not found.
3	Hostel Building	Masonry structure. Roof made with Bluescope sheet.	Old Building. Repair,renovation works done in the year 2018-19. Detailing of foundation - Record not found.
4	Kitchen with storeroom	Masonry structure.(Two units) Roof made with Bluescope sheet & adbestos sheet	Old Building

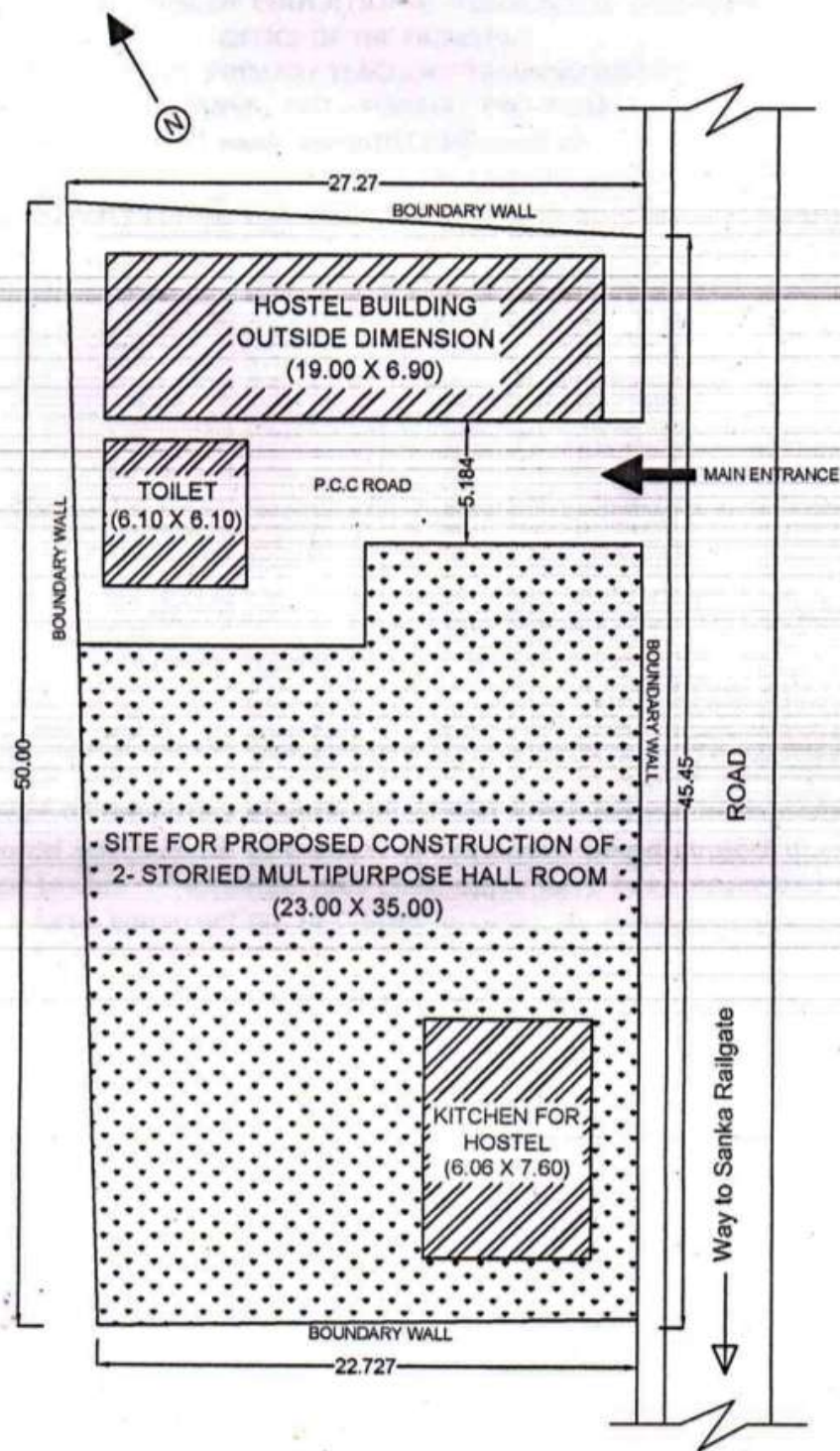

SITE PLAN OF SANKA GOVT. P.T.T.I HOSTEL CAMPUS
MOUZA- SANKA, J.L NO-116, PLOT NO-5003.
LATITUDE- 23.5263, LONGITUDE- 86.6279

All Dimensions are in Meter.
Scale- N.T.S

Sl no	Building Name	Description of building	Remarks
1	HOSTEL BUILDING	Masonry structure. Roof made with G.C.I sheet.	Old building
2	KITCHEN FOR HOSTEL	Masonry structure. Roof made with Adbestos sheet.	Old dilapilated unused building for a long time.